



# BROOKSIDE TERRACE APARTMENTS

120 Tilbury Avenue,  
Bedford, NS

## HORSESHOE

1199 sq ft

The floor plan illustrated here includes these finishes:

### CABINETRY:



White    High-gloss White    Charcoal

### COUNTERS:



Laminate    Quartz

### FLOORING:

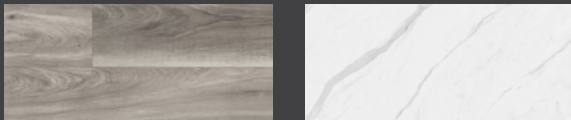

Luxury vinyl plank    Ceramic tile

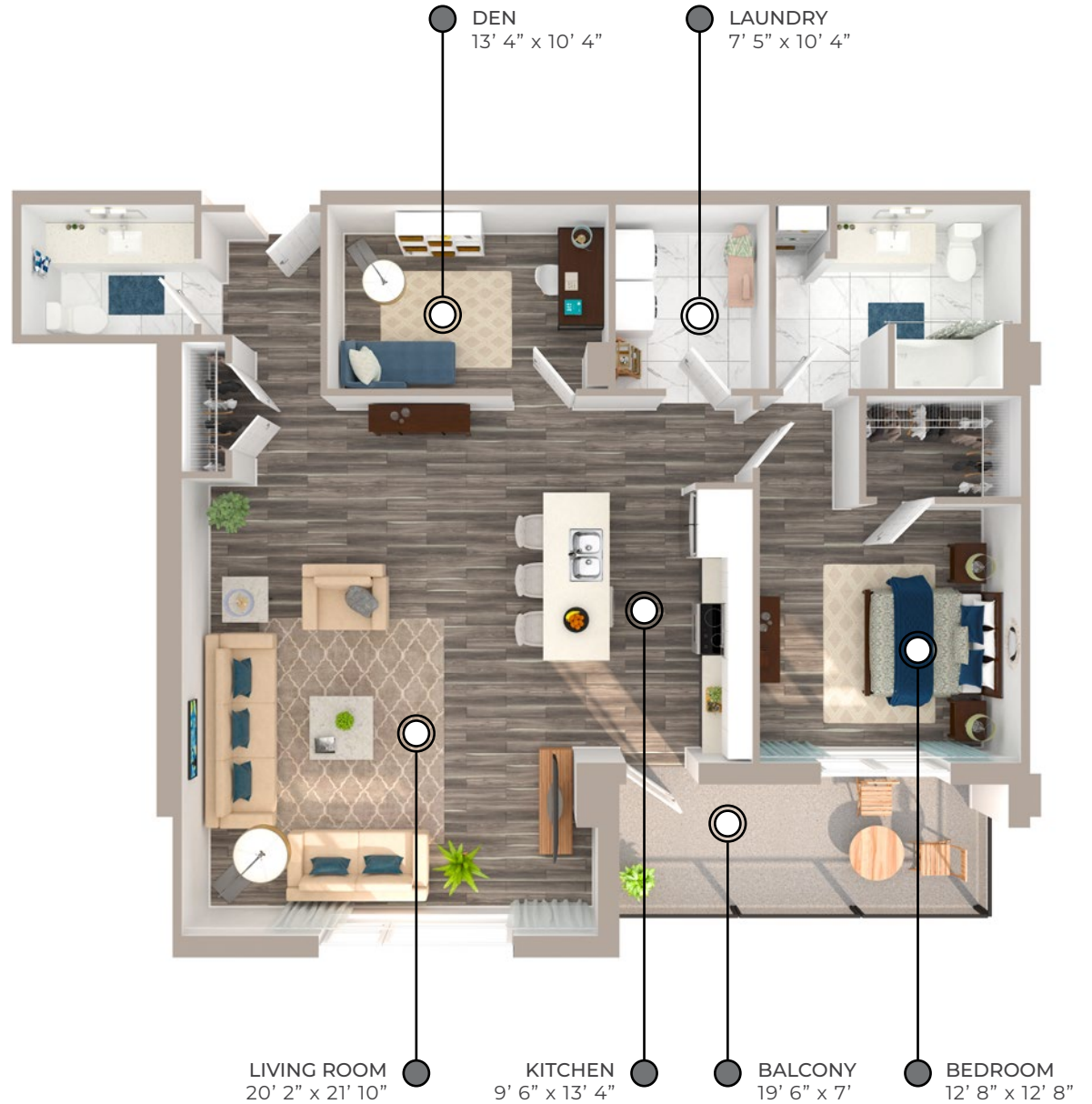

Please note, all floor plans and photos are provided for illustrative purposes only. **ALL MEASUREMENTS ARE APPROXIMATE.** Actual layouts may be different than shown and could vary in size and scale.



**BROOKSIDE  
TERRACE**  
APARTMENTS

120 Tilbury Avenue,  
Bedford, NS

---

**HORSESHOE**

**1199** sq ft

---

**First Floor**

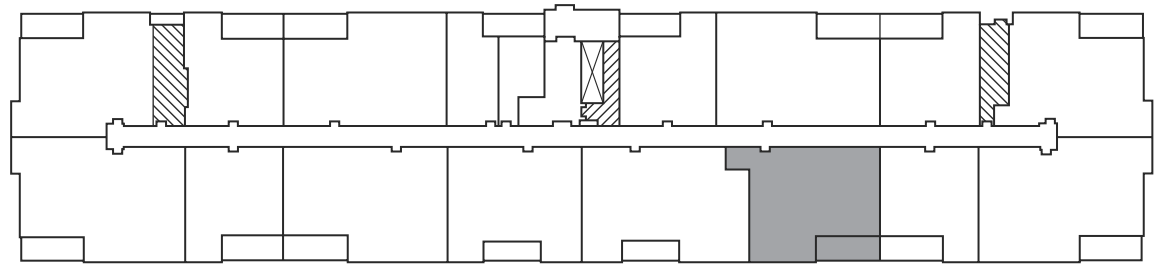

**Second Floor – Sixth Floor**

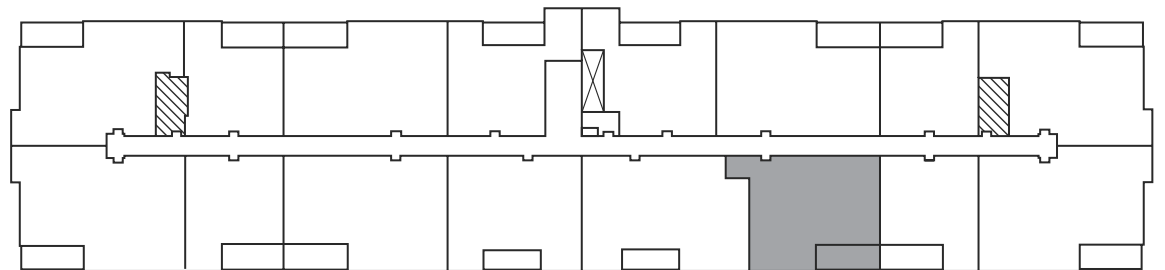

 Elevator  Stairwell