



# MEREWOOD APARTMENTS

411 & 423 Despard Avenue  
Parksville, BC

## CHERRY

728 sq ft

The floor plan illustrated here includes these finishes:



**CABINETRY:**  
FLAT SLAB

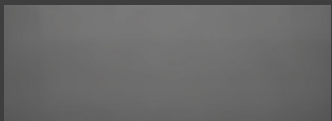

**COUNTERS:**  
QUARTZ

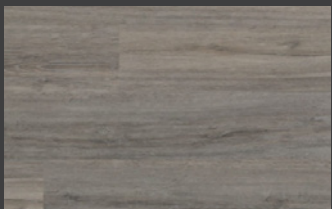

**FLOORING:**  
LUXURY  
VINYL TILE



**CARPET:**  
TEXTURED  
CUT PILE



All suite measurements are preliminary based on current building concept and unit configurations and are subject to change.



# MEREWOOD APARTMENTS

411 & 423 Despard Avenue  
Parksville, BC

---

## CHERRY

**728** sq ft

---

### 411 Despard Avenue

#### First Floor

Suite: 108

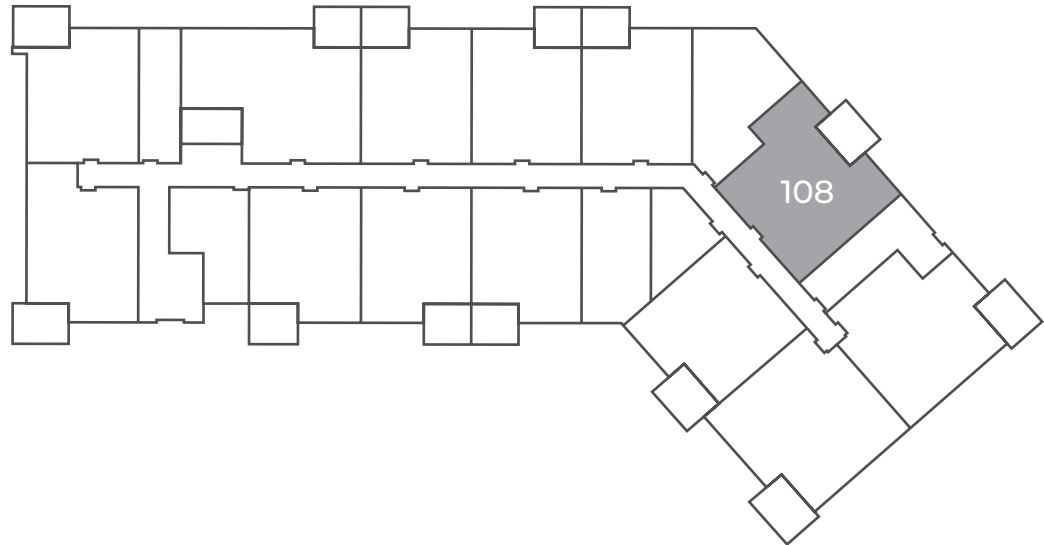



# MEREWOOD APARTMENTS

411 & 423 Despard Avenue  
Parksville, BC

## LILAC

643 sq ft

The floor plan illustrated here includes these finishes:



**CABINETRY:**  
FLAT SLAB

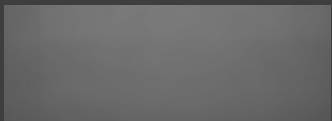

**COUNTERS:**  
QUARTZ

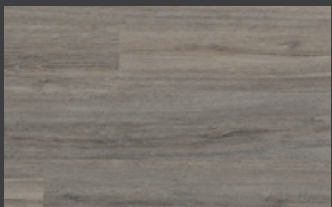

**FLOORING:**  
LUXURY  
VINYL TILE



**CARPET:**  
TEXTURED  
CUT PILE

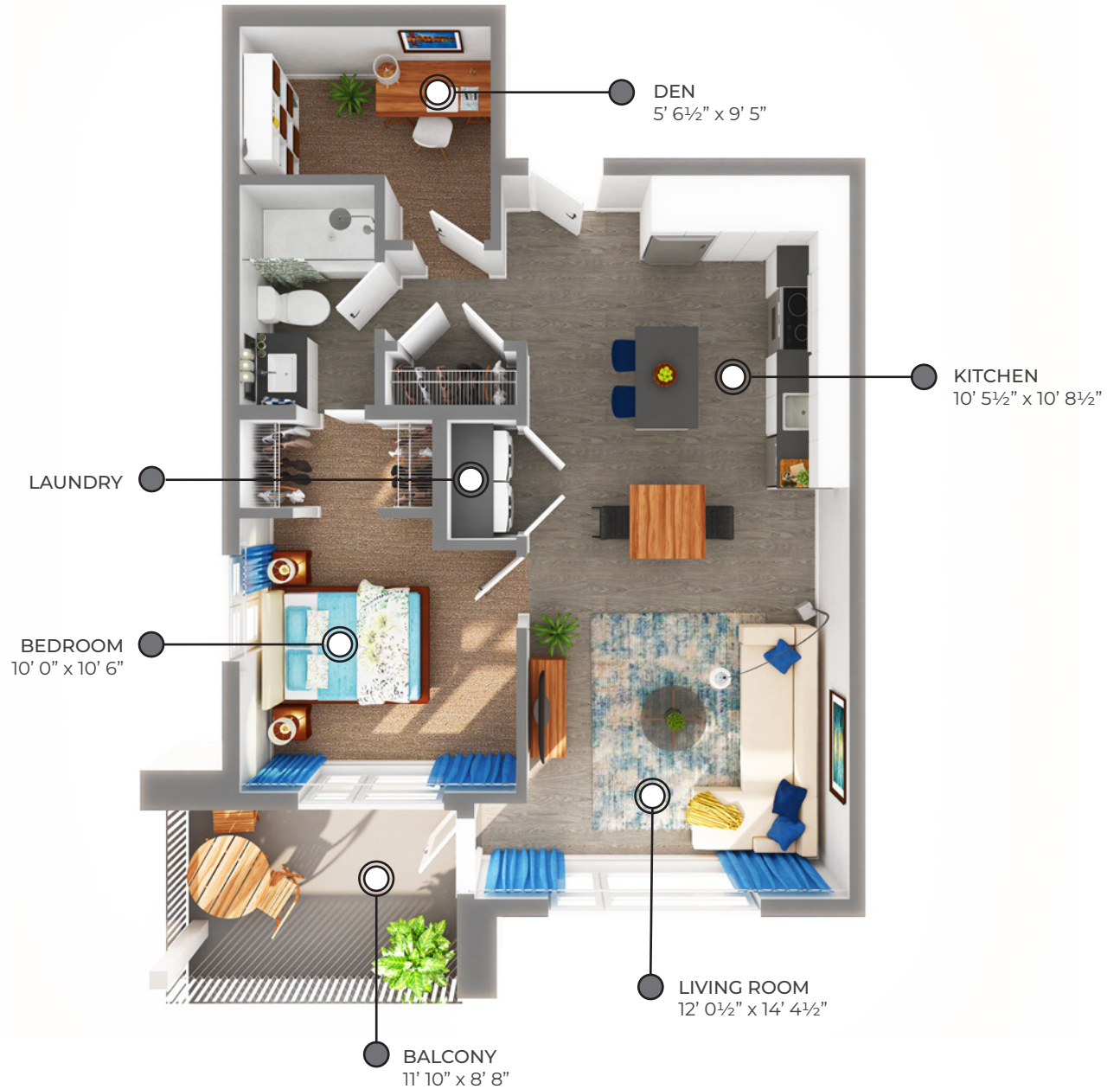

All suite measurements are preliminary based on current building concept and unit configurations and are subject to change.



# MEREWOOD APARTMENTS

423 Despard Avenue  
Parksville, BC

LILAC

643 sq ft

## 411 Despard Avenue

### First Floor

Suite: 101

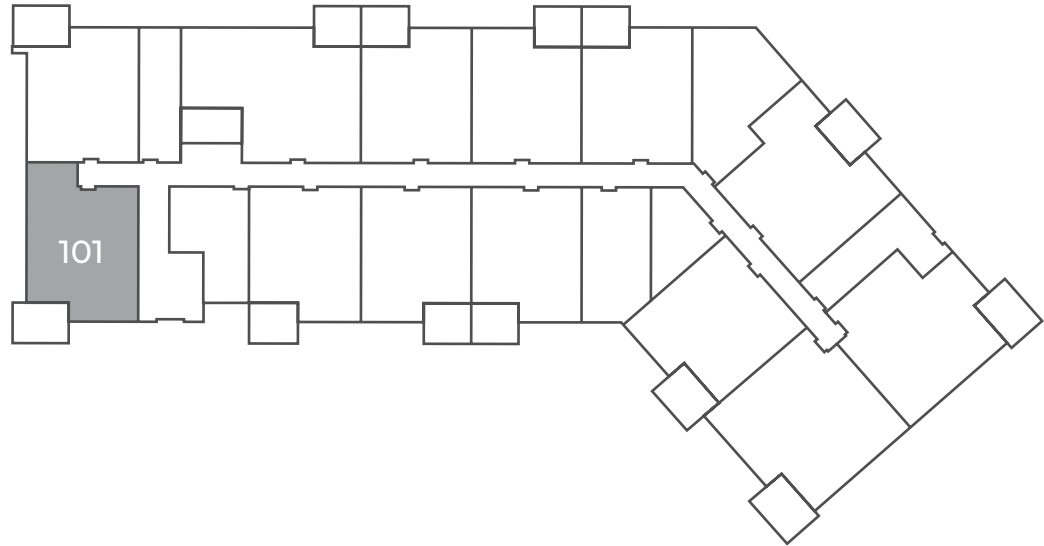

### Second Floor - Fourth Floor

Suites: 202, 302, 402

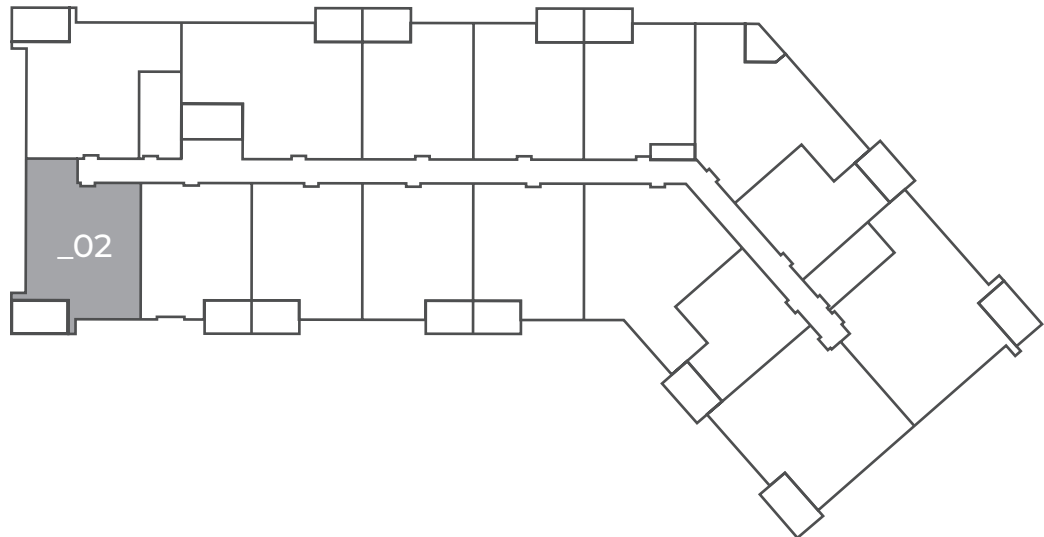



# MEREWOOD APARTMENTS

411 & 423 Despard Avenue  
Parksville, BC

## MAGNOLIA

667 sq ft

The floor plan illustrated here includes these finishes:



**CABINETY:**  
FLAT SLAB

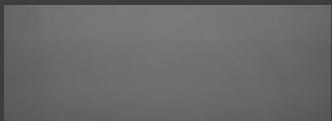

**COUNTERS:**  
QUARTZ

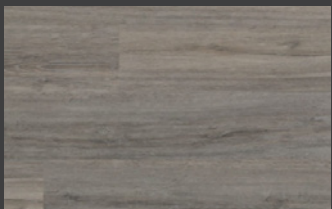

**FLOORING:**  
LUXURY  
VINYL TILE



**CARPET:**  
TEXTURED  
CUT PILE

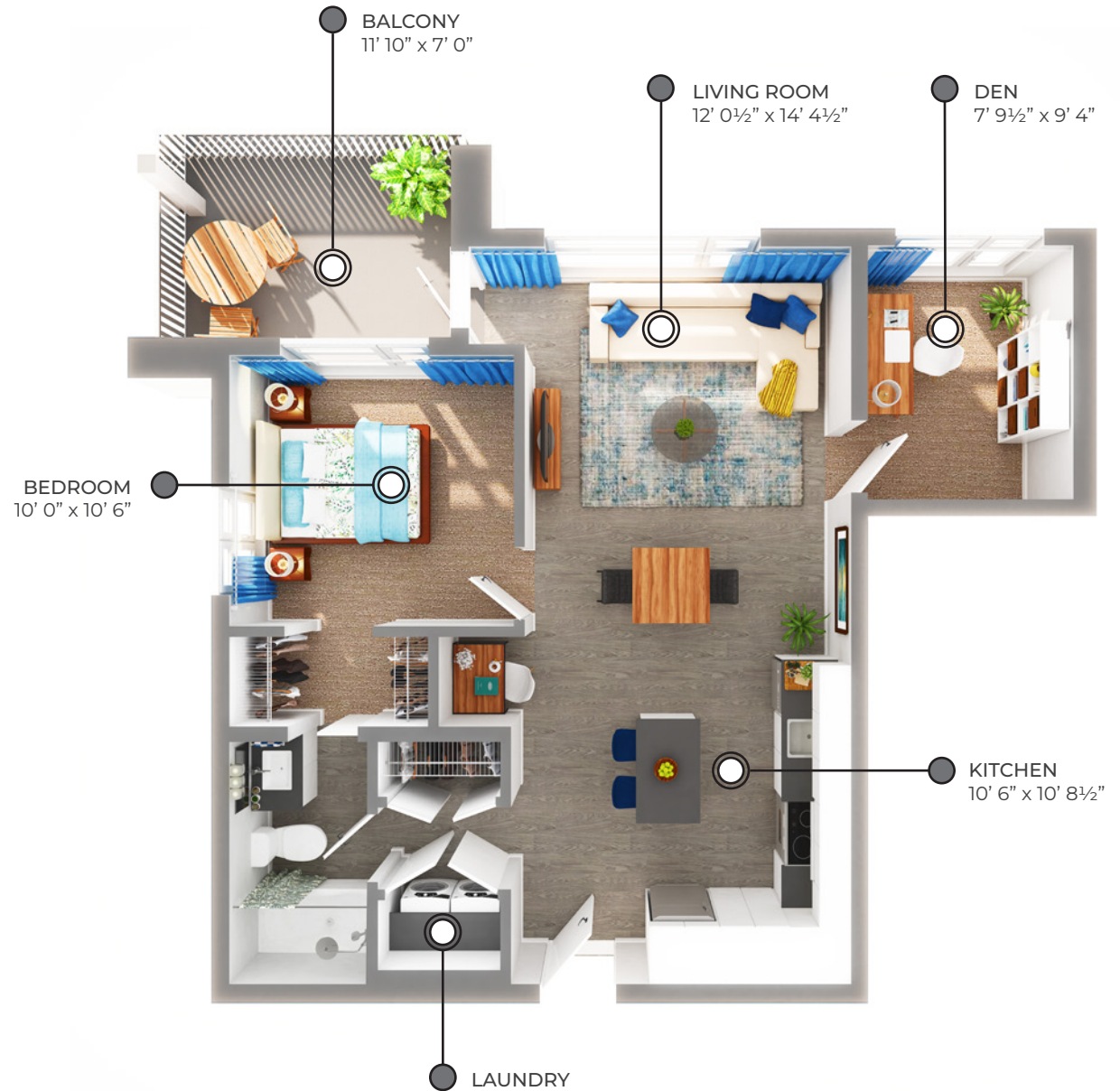

All suite measurements are preliminary based on current building concept and unit configurations and are subject to change.



# MEREWOOD APARTMENTS

411 & 423 Despard Avenue  
Parksville, BC

## MAGNOLIA

**667** sq ft

### 411 Despard Avenue

#### Second Floor – Fourth Floor

Suites: 203, 303, 403

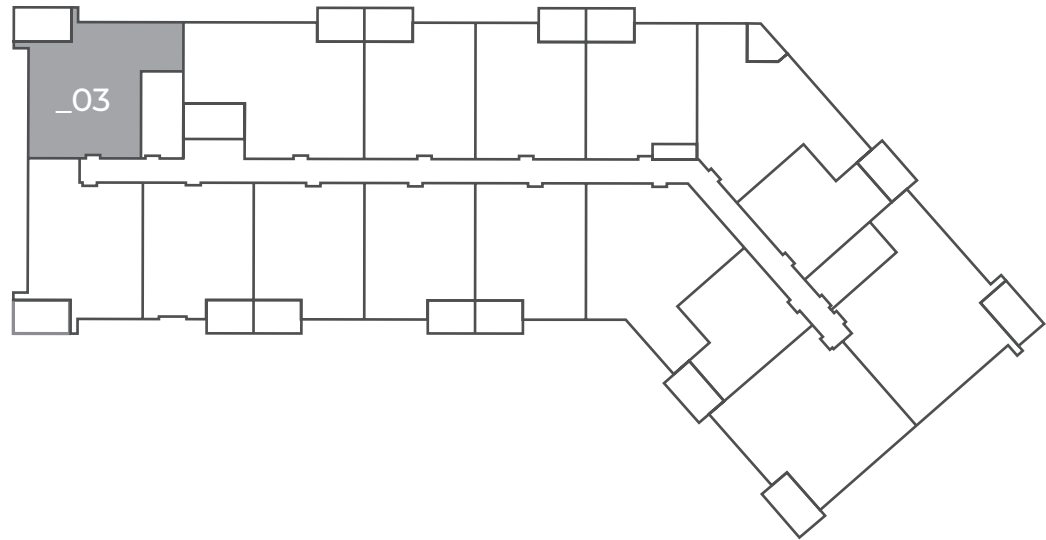



# MEREWOOD APARTMENTS

411 & 423 Despard Avenue  
Parksville, BC

## PEAR 688-695 sq ft

The floor plan illustrated here includes these finishes:



**CABINTRY:**  
FLAT SLAB

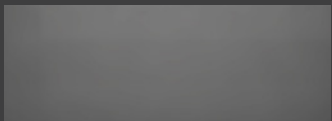

**COUNTERS:**  
QUARTZ

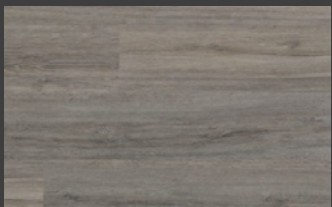

**FLOORING:**  
LUXURY  
VINYL TILE



**CARPET:**  
TEXTURED  
CUT PILE

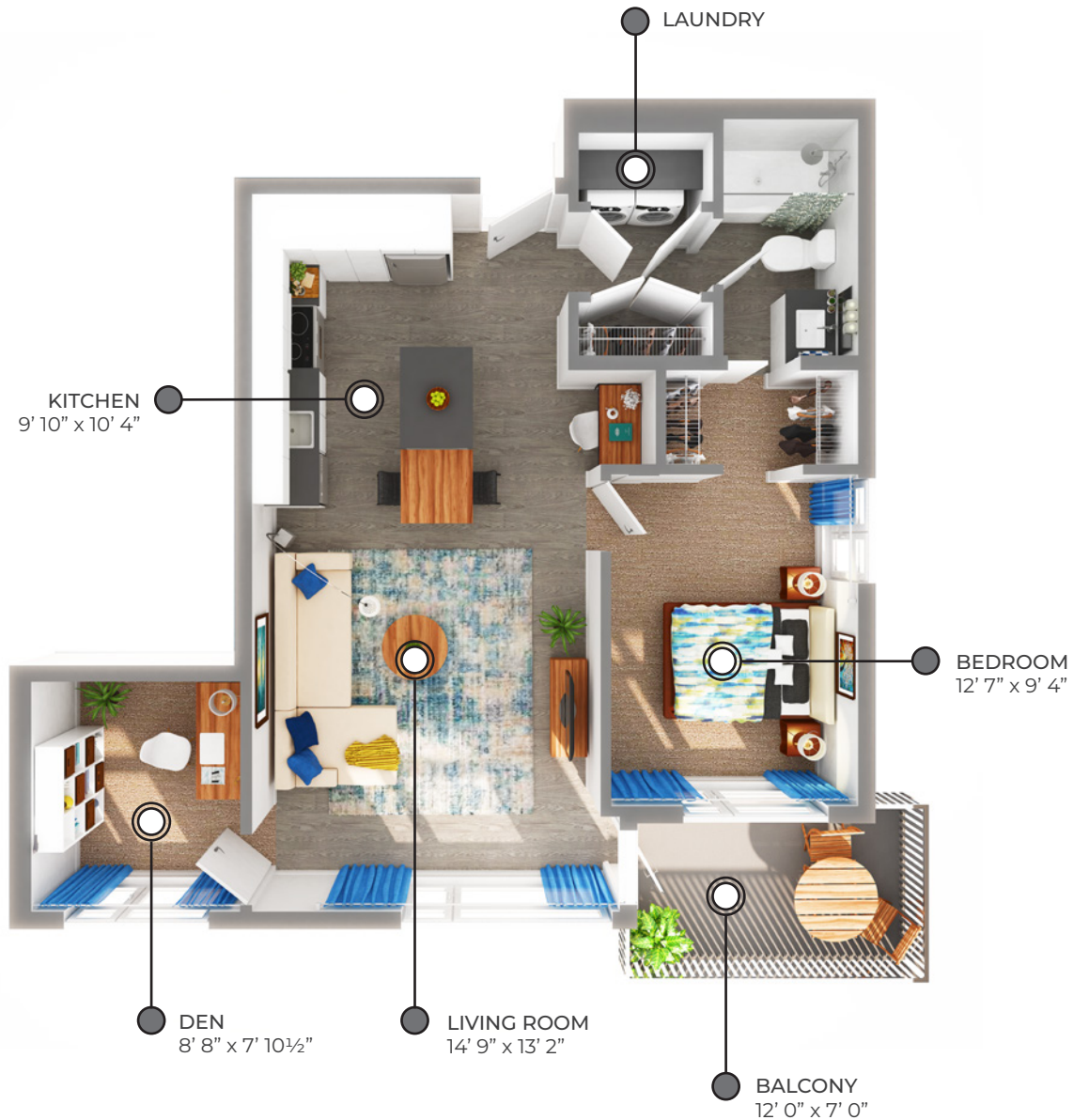

All suite measurements are preliminary based on current building concept and unit configurations and are subject to change.



# MEREWOOD APARTMENTS

411 & 423 Despard Avenue  
Parksville, BC

---

PEAR  
**688-695** sq ft

---

## 423 Despard Avenue

### Second Floor – Fourth Floor

Suites: 207, 307, 407

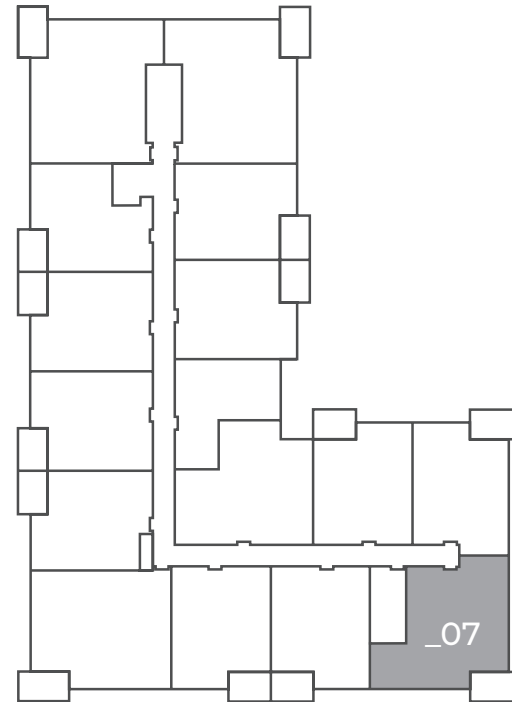





# MEREWOOD APARTMENTS

411 & 423 Despard Avenue  
Parksville, BC

## PLUM 714 sq ft

The floor plan illustrated here includes these finishes:



**CABINETRY:**  
FLAT SLAB

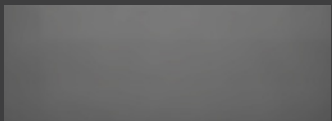

**COUNTERS:**  
QUARTZ

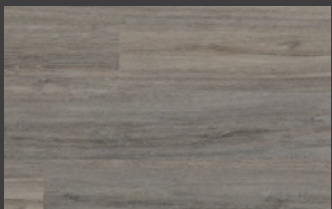

**FLOORING:**  
LUXURY  
VINYL TILE



**CARPET:**  
TEXTURED  
CUT PILE

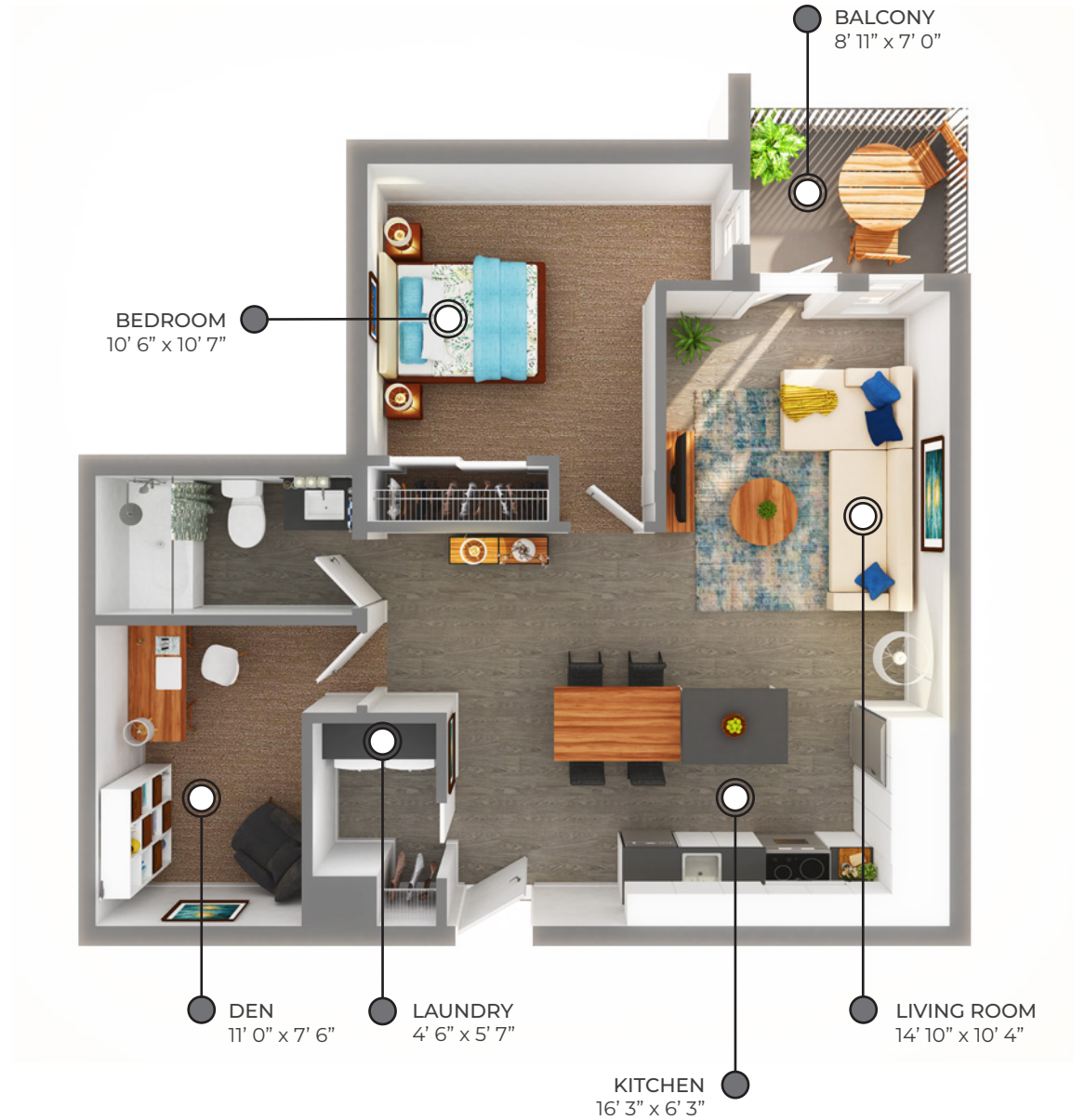

All suite measurements are preliminary based on current building concept and unit configurations and are subject to change.



# MEREWOOD APARTMENTS

411 & 423 Despard Avenue  
Parksville, BC

---

PLUM

**714** sq ft

---

## 423 Despard Avenue

**Second Floor – Fourth Floor**

Suites: 204, 304, 404

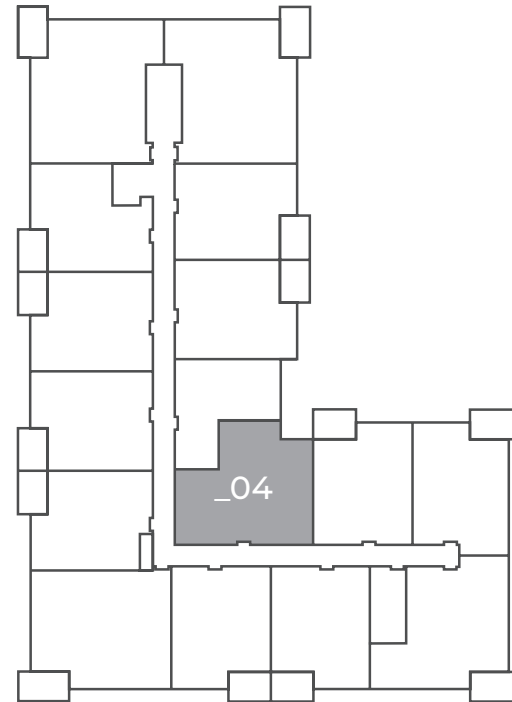



# MEREWOOD APARTMENTS

411 & 423 Despard Avenue  
Parksville, BC

## ROSE 632 sq ft

The floor plan illustrated here includes these finishes:



**CABINETY:**  
FLAT SLAB

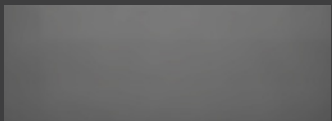

**COUNTERS:**  
QUARTZ

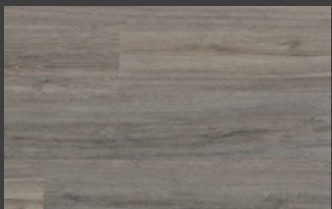

**FLOORING:**  
LUXURY  
VINYL TILE



**CARPET:**  
TEXTURED  
CUT PILE

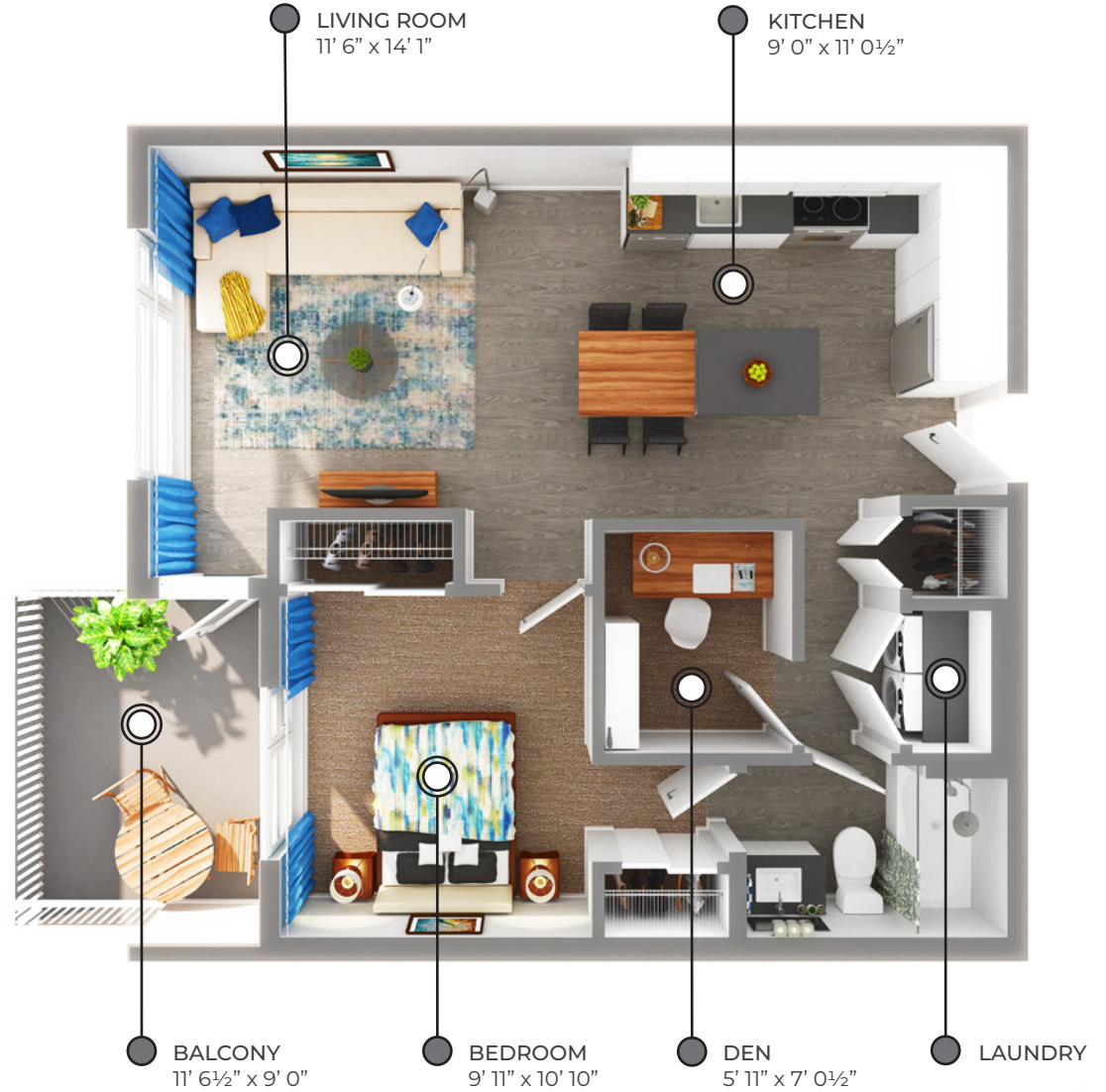

All suite measurements are preliminary based on current building concept and unit configurations and are subject to change.



# MEREWOOD APARTMENTS

411 & 423 Despard Avenue  
Parksville, BC

---

## ROSE

**632** sq ft

---

### 411 Despard Avenue

#### First Floor

Suite: 111

